

REV	ECN NO	DESCRIPTION	DATE	APPROVED
AA	-	NEW RELEASED	2017.03.15	CLARA

Customer drawing

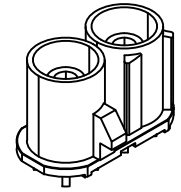

3D View

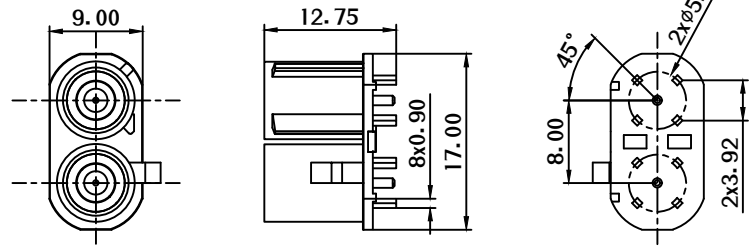

- Electrical specifications
 - Impedance: 50Ω
 - Frequency range: DC to 6 GHz
 - Return loss: ≥23dB min (DC to 4 GHz)
≥20dB min (4 GHz to 6 GHz)
 - Insertion Loss: ≤0.1x√f(GHZ)dB
 - Contact resistance: 5 mΩ max
 - Voltage range: 60V max
 - Current range: 1A DC max
 - Dielectric withstanding voltage: 750V AC min
 - Insulation resistance: 1000 MΩ min

- Material specifications
 - Insulation: PTFE, UL94V-0
 - Center Contact: 2xø0.92, Brass, plated gold
 - External Contact: 8x0.9, Brass, plated tinned
 - Plastic Housing: PA, Black, UL94V-0

- Mechanical properties
 - Durability: ≥25Cycles Min
 - Temperature range: -40°C~+105°C
 - Insertion force: 65N max
 - Withdrawal force: 2N min
 - Retention force latch: 110N min
 - Coding efficiency: 40N min
 - Interface According to DIN 72594-1

4. Marking "★" as key control dimensions

Connector Table 1

Bomcan Connector Part Number	Coding	Color
2FK2-A-ST-01	A	Black
2FK2-B-ST-01	B	White
2FK2-C-ST-01	C	Blue
2FK2-D-ST-01	D	Bordeauxviolet
2FK2-E-ST-01	E	Green
2FK2-F-ST-01	F	Brown
2FK2-G-ST-01	G	Gray
2FK2-H-ST-01	H	Violet
2FK2-I-ST-01	I	Beige
2FK2-K-ST-01	K	Curry
2FK2-L-ST-01	L	Carmine red
2FK2-M-ST-01	M	Psstel orange
2FK2-N-ST-01	N	Pastel green
2FK2-Z-ST-01	Z	Water blue

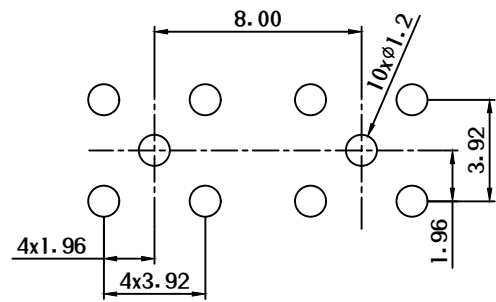
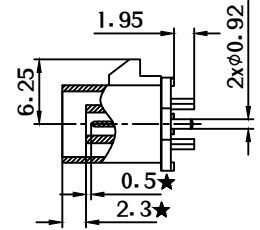

RECOMMENDED PCB LAYOUT
TOLERANCE: ±0.05



UNMARKED TOLERANCES	
DIMENSIONS	TOLERANCE
x.	±1.0
x.x	±0.5
x.xx	±0.25
0 to 500	+15 / -0
< 501	+3% / -0 of length
ANGLES	
x°	±1°



This drawing contains information that is proprietary to BOMCAN and should not be used without written permission. Powered by bomcan.com

DESCRIPTION	DUAL FAKRA STRAIGHT PLUG FOR PCB CONNECTOR			
DWG NO	-	BOMCAN PART No	2FK2-★-ST-01	
DRAWN BY	CLARA 2017.03.15	CUSTOMER P/N	-	
CHECKED BY	CALEB 2017.03.15	SIZE: A3	SHEET	UNIT
APPROVED BY	BILL 2017.03.15	REV: AA	1 of 2	mm
		SCALE	Free	Third angle projection

A3

REV	ECN NO	DESCRIPTION	DATE	APPROVED
AA	-	NEW RELEASED	2017.03.15	CLARA

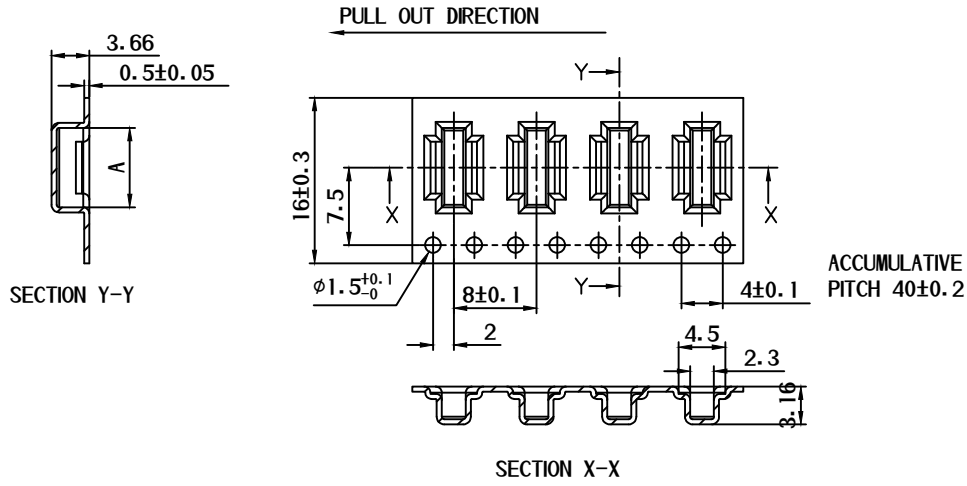
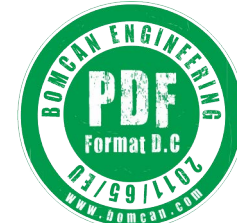

ACCUMULATIVE PITCH 40±0.2

NOTES

1. DETAIL DIMENSION, SEE PRODUCT DRAWING.
2. NUMBER OF CONNECTORS: 3300PCS/REEL.
NUMBER OF DELIVERY UNIT: 20,30CKT. 13200PCS/CARTON.
40,60CKT. 9900PCS/CARTON.
3. LEAD TAPE LENGTH.

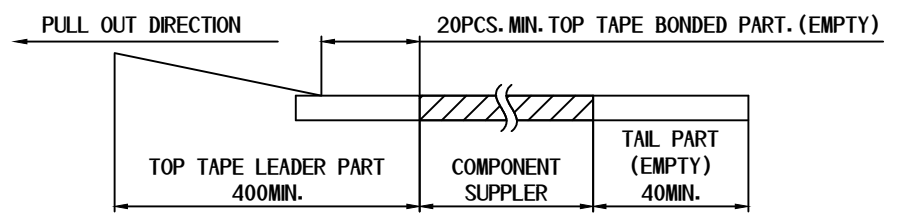

4. TOP TAPE PEEL FORCE IS DEFINED BY IEC60286-3.
5. MATERIAL
CARRER TAPE: POLYSTYRENE
TOP TAPE: PET, OTHER
REEL: POLYSTYRENE(PS)(RECYCLE MATERIAL CONTAINED)

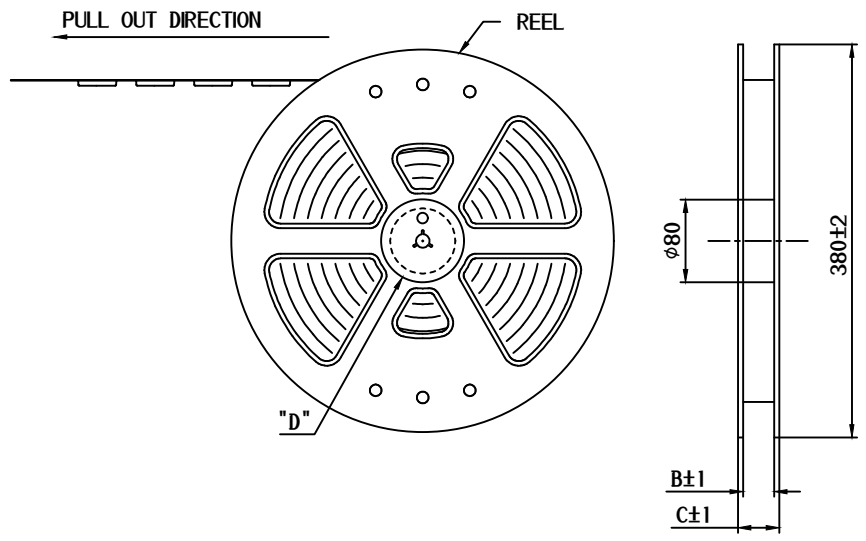

UNMARKED TOLERANCES		This drawing contains information that is proprietary to BOMCAN and should not be used without written permission. Powered by bomcan.com			
DIMENSIONS	TOLERANCE				
x.	±1.0	DESCRIPTION	DUAL FAKRA STRAIGHT PLUG FOR PCB CONNECTOR		
x.x	±0.5	DWG NO	-	BOMCAN PART No	2FK2-#-SM-0011
x.xx	±0.25	DRAWN BY	CLARA 2017.03.15	CUSTOMER P/N	-
0 to 500	+15 / -0	CHECKED BY	CALEB 2017.03.15	SIZE: A3	SHEET
< 501	+3% / -0 of length	APPROVED BY	BILL 2017.03.15	REV: AA	2 of 2
ANGLES		UNIT	mm	SCALE	Free
x°	±1°	Third angle projection			